

WEDGE ANCHOR

FIXING COMPONENTS



Description

Galvanized steel 6 mm diameter anchor made for multiple use for non-structural cracked & Un-cracked concrete. The head of the ceiling anchor rests wide, covers neatly and has an expansible split part on the other side. Suitable For Fire Rated Systems. They are specially used for fixing off hangers, brackets, and all kind of drywall profiles to concrete slabs where high workload, safety and extreme rapidity of installation is required.

Basic Uses

Wedge Anchor IS Applicable for all all-Drywall Systems – Suspended Ceilings, sub structures, profiles, ventilation systems & wire Hangers

Advantages

- High mechanical strength
- Excellent dimensional stability
- Compatible with all major façade Systems
- Simple installation
- Reliable setting thanks to simple visual check
- For fixing in cracked concrete, redundant fastening only

Technical Data

Physical Properties

Standard Compliance	BS 212.15
Material	Cold-formed steel
Coating	Zinc coating
Size	6X40 & 6X70

Installation

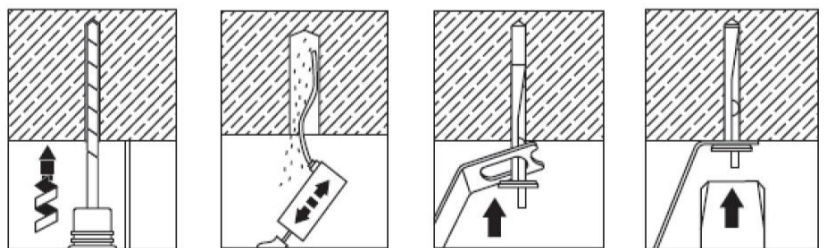

Drill hole with drill bit.

Blow out dust and fragments.

Install anchor with suspended item.

Hammer in anchor.

*Wedge Anchor is an outsourced product

Get in touch

info@gypsemna.com
www.gypsemna.com

technical@gypsemna.com
linkedin.com/company/gypsemna-company-llc/

